

On the following pages you will find the model series:

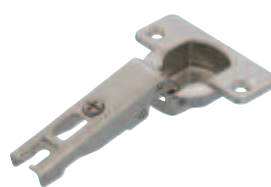

Metallamat A
(slide-on system)



Metallamat SM
(quick fixing system)

4

Mounting door to cabinet

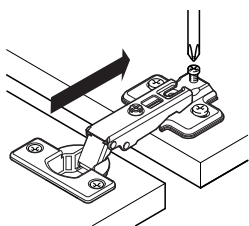

Metallamat A slide-on system

Hinge arm is slid onto mounting plate and screwed in position.

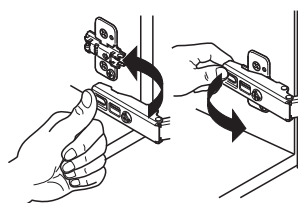

Metallamat SM quick fixing system

Hinge arm is positioned and clipped onto mounting plate. It can easily be removed from the mounting plate.

Attachment methods

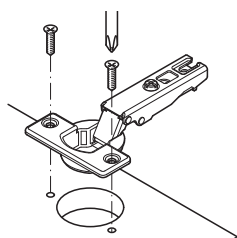

Cup for screw fixing

Cup fixing with chipboard screws with countersunk head

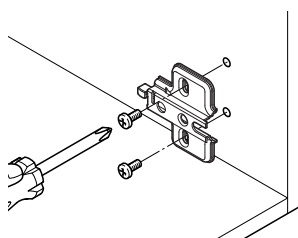

Mounting plate for screw fixing

Fixing with chipboard screws or with pre-mounted Euro screws into 32 mm series drilled holes.

Adjustment facilities

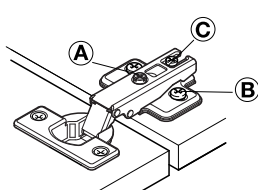

- A** Side adjustment
Adjusting distance on concealed hinge +3 mm
- B** Height adjustment
Via mounting plates adjusting distance ± 2 mm
- C** Depth adjustment
Adjusting distance on concealed hinge +4 mm, -1 mm



Processing and mounting deviations can be corrected with the 3-dimensional adjusting facility.

Factory settings

Side, height and depth adjustment: Zero position

Mounting

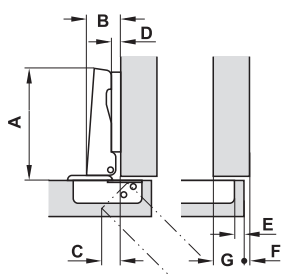

- A** Hinge arm length
- B** Hinge arm height
- C** Door offset
- D** Distance (mounting plate)
- E** Distance to cup
- F** Gap
- G** Door overlay

Mounting options

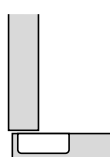

Full overlay mounting
Concealed hinge with straight arm

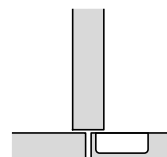

Half overlay mounting
Concealed hinge with cranked arm

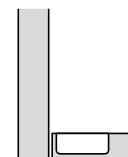

Inset mounting
Concealed hinge with high cranked arm

Drilling pattern

For screw fixing

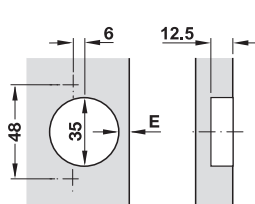

Drilling pattern 48/6

For press fitting

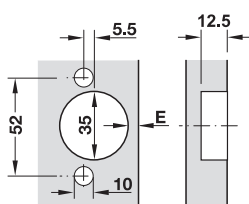

Drilling pattern 52/5.5

Cup dimensions

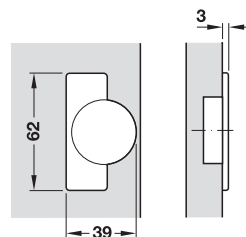

Cruciform mounting plate

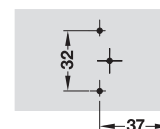

Determining the minimum gap that is required

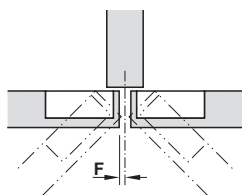

The required minimum gap depends on the hinge type, distance to cup and door thickness. Once the door thickness and the distance to cup have been determined, the minimum gap is shown in the application table.

Example:

With a door thickness of 19 mm and a distance to cup of 4 mm a minimum gap of 2 mm is required.

Door thickness mm	Distance to cup mm			
	3	4	5	6
16	1.2	1.2	1.1	1.1
18	1.7	1.7	1.6	1.6
19	2.0	2.0	1.9	1.9
20	2.4	2.3	2.2	2.2
22	3.3	3.1	3.0	2.9
24	4.5	4.2	4.0	3.9
26 – 32	Trial mounting is recommended			

Number of concealed hinges per door

The values in the table are sample measurements. Trial mounting is recommended.

The number of concealed hinges per door depends on:

- Door width and height
- Door weight
- Door material

According to the example diagram, three concealed hinges have to be fitted with a door height of 1,600 mm and a door weight of 6 – 9 kg.

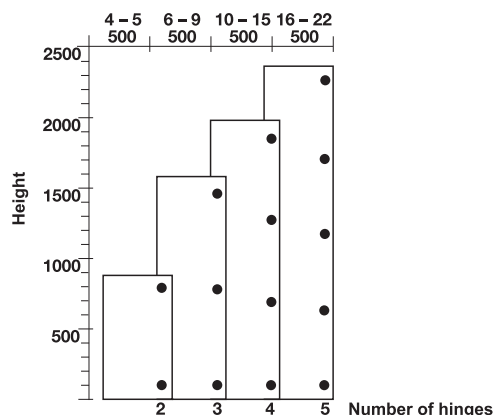

Choice of mounting plate

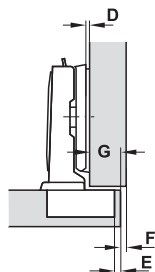

The different distance heights of the mounting plates allow adjustments to be made to the door overlay. The distance is determined by the mounting plate thickness. The starting point for determining the required distance is the desired type of mounting with a defined door overlay.

- D** Distance
- G** Door overlay
- F** Gap
- E** Distance to cup

Example

Door overlay mm

4	5	6	7	8	9	10	11	12	13	
					3	4	5	6	7	3
				3	4	5	6	7		4
		3	4	5	6	7				6
3	4	5	6	7						8
Distance to cup E mm										Mounting plate distance mm

Once the door overlay and the distance to cup have been determined, the distance can be looked up in the application table. In the example the door overlay is defined at 10 mm and the distance to cup at 5 mm. This produces a distance of 4 mm.

Metallamat A/SM 110°

For standard applications



Full overlay mounting with mounting plate



→ Full overlay mounting

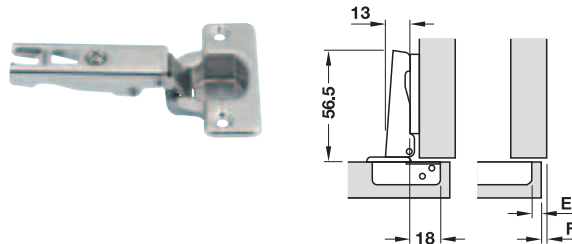

- Hinge arm: Straight

- Material: Steel cup and hinge arm
- Finish: Nickel plated
- Cup fixing: For screw fixing
- Installation: Door to cabinet with slide-on system A or with quick fixing system SM
- Drilling depth: Hinge cup 12.5 mm
- Adjustment facility: 3-dimensional (with appropriate mounting plate)
- With automatic closing spring

Note

Dimensions and gap specifications in drawings and tables are calculated:

- Using factory settings
- For mounting plate distance 0 mm

Door thickness mm	Distance to cup mm				
	3	4	5	6	7
15	0.6	0.6	0.6	0.6	0.6
16	0.8	0.8	0.8	0.8	0.8
17	1.1	1.0	1.0	1.0	1.0
18	1.4	1.4	1.3	1.3	1.3
19	1.8	1.7	1.7	1.6	1.6
20	2.2	2.1	2.0	2.0	2.0
21	2.8	2.6	2.5	2.4	2.3
22	3.4	3.1	3.0	2.8	2.7
23	4.1	3.8	3.6	3.3	3.2

Door overlay mm

13	14	15	16	17	18	19	20	21	22	23	A	SM
						3	4	5	6	7	2	
					3	4	5	6	7			3
				3	4	5	6	7			4	4
		3	4	5	6	7					6	6
3	4	5	6	7							8	8

Distance to cup E mm

Mounting plate distance mm

Mounting plates are available for slide-on system (A) with 2, 4, 6 and 8 mm, for quick fixing system (SM) with 3, 4, 6 and 8 mm.

Cup fixing	Drilling pattern	
	48/6	52/5.5
Slide-on system A		
For screw fixing	316.30.500	–
For press fitting	316.30.510	–
For press fitting	–	316.30.530
Quick fixing system SM		
For screw fixing	318.40.500	–

Packing: 250 pieces